

KEY

 PLOT BOUNDARY

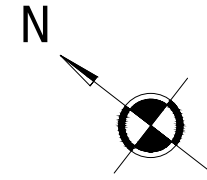
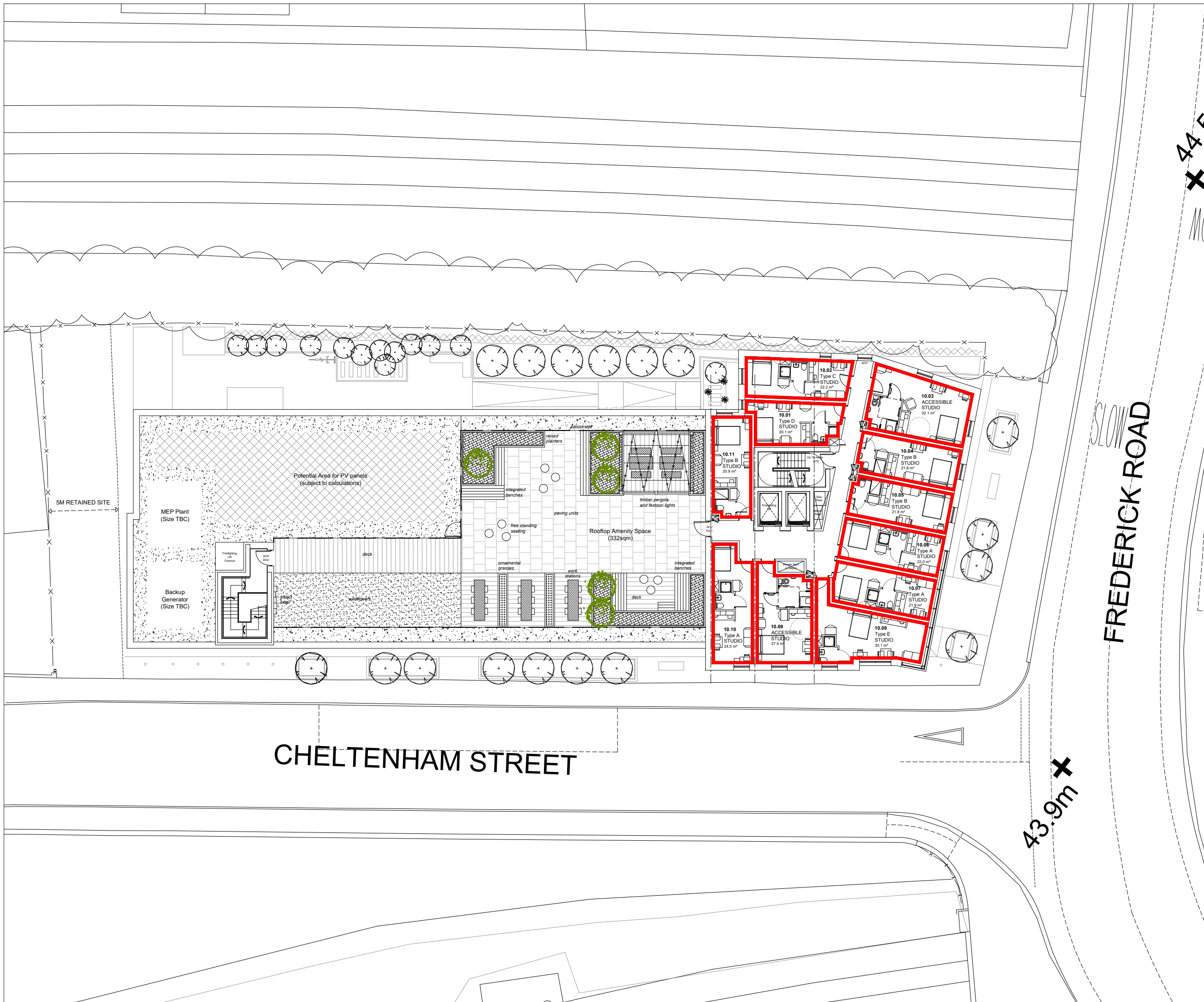

DO NOT SCALE OFF THIS DRAWING © LEACH RHODES WALKER 2001

LeachRhodesWalker
Architects

info@lrw.co.uk | www.lrw.co.uk
H.Q. 50 Dearmans Place Manchester M3 5LH

Manchester +44 (0)161 833 0211 **London** +44 (0)207 993 1363

client X1 DEVELOPMENTS LTD			
project CHELTENHAM STREET SALFORD			
project no 8194	drawing no L(25)715	rev .	
description - Tenth Floor Land Registry Approval Plan			
scale 1:250 @ A3	date drawn 14.06.22	drawn by WI	authorised by CJG
<p><small>File: C:\Users\Stuart.P\Documents\Projects\8194\8194_L(25)715\14.06.22\14.06.22_Land Registry Approval Plan - Tenth Floor.dwg</small></p> <p>purpose of issue <input type="checkbox"/> planning <input type="checkbox"/> building regs <input type="checkbox"/> tender <input type="checkbox"/> prelim./comment <input type="checkbox"/> approval <input checked="" type="checkbox"/> construction </p>			